

Robust LED safety luminaire with optimised light distribution for the illumination of escape routes. Leuchte aus gebürstetem Edelstahl mit hoher Schutzart. Self-monitoring self contained LED luminaires incl. high-quality high-temperature cells. Suitable for the usage in outdoor areas due to an outsourced supply unit.

External supply unit: IP66; Ta: -5...+40 °C

Technical data

Rated duration:	1h;1,5h;2h;3h;8h	Inrush current:	11 A / 64 µs
Battery type:	Ni-MH 4,8 V 1,1 Ah	Protection class:	II
Material:	stainless steel	Input terminals:	max. 2,5mm ² single-core
Illuminant:	1 x 0,9W LED-module	Temperature ta:	-15...+40 °C
Nominal voltage AC:	230V AC ±10% 50/60 Hz	Impact resistance:	IK10

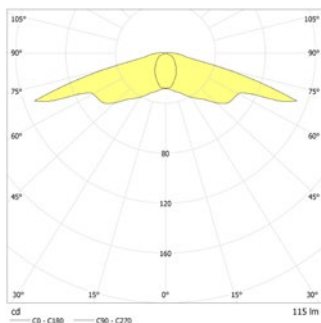

Ceiling mounting: Minimum illumination 1.0lx (middle of escape route), Maintenance factor 0.8

h	2.5	3.0	3.5	4.0	4.5	
1h ☺	95%	2.5	4.3	13.3	4.8	1.7
3h ☺	60%	2.5	3.5	10.0	3.9	1.3
8h ☺	30%	2.5	3.0	9.8	3.9	1.0

Articles

BN/V 804.2 AP -03 ALB SV/B LED 1-8/D				
Colors	stainless steel	RAL 9016	HWF (special)	RAL (special)
Art. no.	102067339	102046121	102046020	102046222

ceiling mounting for exposed wiring Light colour: 4000 K Protection category: IP65

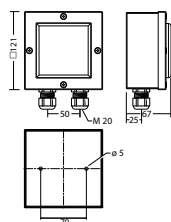

BN/V 804.2 D -03 ALB SV/B LED 1-8/D				
Colors	stainless steel	RAL 9016	HWF (special)	RAL (special)
Art. no.	102067036	102018233	102018132	102018334

ceiling mounting Light colour: 4000 K Protection category: IP65

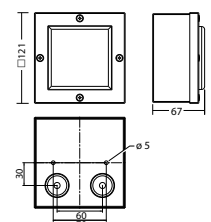

BN-supply AP SV/B LED - 1-8/DSKII IP66	Art. no. 102024091
--	--------------------

required

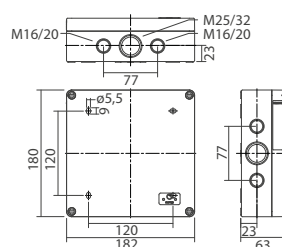

Name	Accessories	Art. no.
BN-supply AP SV/B LED - 1-8/DSKII IP66	required	102024091
Ceiling recessed frame SN 804.2 D	optional	102022374