

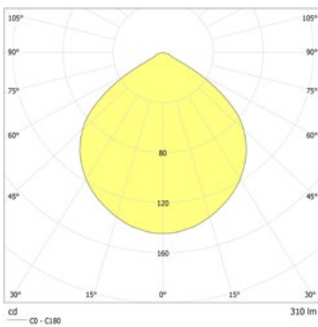

Elegant LED downlight with asymmetric light distribution ideal for escape route illumination. Powder-coated metal cover without any visible screws. Designed for tool-less recessed ceiling installation in a ceiling cut-out Ø 68mm.

Technical data

Rated duration:	1h;1,5h;2h;3h;8h	Nominal current AC:	33 mA
Luminous flux:	1h = 65% ; 3h = 30% ; 8h = 15%	Apparent power:	7,5 VA
Battery type:	Ni-MH 4,8 V 1,1 Ah	Inrush current:	11 A / 64 µs
Material:	sheet steel powder-coated	Protection class:	II
Illuminant:	3 x 1W LED-module	Input terminals:	max. 2,5mm ² single-core
Nominal voltage AC:	230V AC ±10% 50/60 Hz	Temperature ta:	M: -5...+35 °C, NM: 0...+40 °C



Minimum illumination 1.0lx (area illumination),
Maintenance factor 0.8

h [m]	1h	3h	8h
2.5	3.2	2.5	1.6
3.0	3.5	2.4	1.4
4.0	3.6	2.1	0.9
5.0	3.5	1.7	0.9
6.0	3.0	1.6	1.6
7.0	2.1	1.7	1.4
10.0	1.0	1.0	0.9

Articles

BN 9104.1 -3 SV/B LED 1-8/D round			
Colors	-	RAL 9016	RAL (special)
Art. no.	101410567	101410466	101410668

recessed ceiling mounting Light colour: 6500 K Protection category: IP20

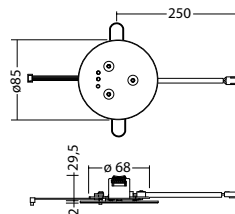
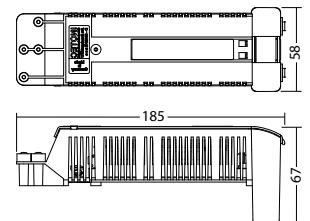
LED-supply BN 1-8/D ext. Art. no. 101441384

Name	Accessories	Art. no.
LED-supply BN 1-8/D ext.	required	101441384