

Elegant LED downlight with asymmetric light distribution ideal for escape route illumination. Powder-coated metal cover without any visible screws. Designed for tool-less recessed ceiling installation in a ceiling cut-out Ø 68mm.

Technical data

Rated duration:	1h;1,5h;2h;3h;8h	Nominal current AC:	33 mA
Luminous flux:	1h = 45% ; 3h = 25% ; 8h = 9%	Apparent power:	7,5 VA
Battery type:	Ni-MH 4,8 V 1,1 Ah	Inrush current:	11 A / 64 µs
Material:	sheet steel powder-coated	Protection class:	II
Illuminant:	2 x 1W LED-module	Input terminals:	max. 2,5mm ² single-core
Nominal voltage AC:	230V AC ±10% 50/60 Hz	Temperature ta:	-15...+40 °C

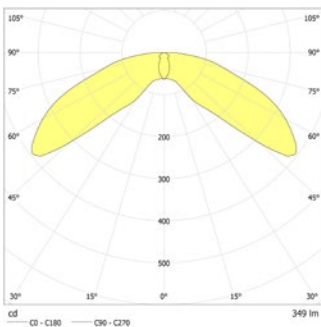

Ceiling mounting: Minimum illumination 1.0lx (middle of escape route), Maintenance factor 0.8

(m)	1h	1.5h	2h	3h	8h
1h	45%				
2.5	1.3	3.4	13.8	5.6	
3.0	1.3	3.5	15.0	6.2	
4.0	0.9	3.7	17.1	6.7	
5.0	0.2	2.2	11.9	6.1	
3h	25%				
2.5	0.9	2.7	11.8	4.7	
3.0	0.7	2.7	12.8	5.0	
3.5	0.1	2.6	13.5	0.2	
8h	9%				
2.5	0.1	1.1	5.2	0.2	

Articles

BN 9107 SV/B LED 1-8/D round		
Colors	RAL 9016	RAL (special)
Art. no.	101413193	101413294
recessed ceiling mounting	Light colour: 6500 K	Protection category: IP20

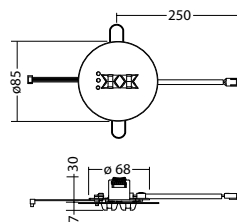

LED-supply BN 1-8/D ext. Art. no. 101441384

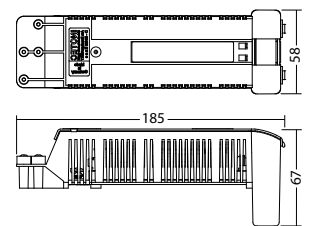

Name	Accessories	Art. no.
LED-supply BN 1-8/D ext.	required	101441384