



Dynamic double-sided straight-line emergency exit sign luminaire made of high quality, powder-coated aluminium. Ideal to display the safe escape route depending on the smoke situation inside a building. For single-sided use, the current consumption is reduced by 50%.

Technical data

viewing distance:	30 m	Nominal current DC:	460 mA
Material:	aluminium powder-coated	Protection class:	III
illuminant:	LED-module	Input terminals:	2.5mm ² feed through wiring
Nominal voltage DC:	24 V ±25 %	Temperature ta:	-15...+40 °C

Articles

FL 1530 D/WA ILDD 24V

Colors	RAL 9016	RAL (special)
Art. no.	100864337	100864438

wall or ceiling mounting

Protection category:
IP40

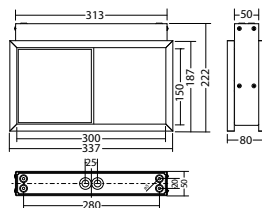

FL 1530 P ILDD 24V

Colors	RAL 9016	RAL (special)
Art. no.	100864741	100864842

pendulum mounting

Protection category:
IP40

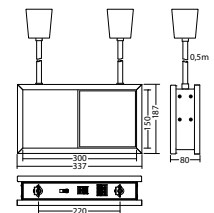

Name	Accessories	Art. no.
AU FL 1530 ILDD 24V PL, RAL 9016	required	101485945
AU FL 1530 WA ILDD 24V PL, RAL9016	required	101486349
AU FL 1530 WA ILDD 24V PR, RAL9016	required	101486551
AU blind plate FL 1530, RAL 9016	optional	100923143
BG Doppelbaldachin FL 1530, RAL 9016	optional	102032579
BG FL 1530 ILDD 24V PR, RAL 9016	required	101486147
Pendulum set SN-luminaire 24 V0,5 m wh	required	101437748
Pendulum set SN-luminaire 24 V1,0 m wh	required	101437950
Pendulum set SN-luminaire 24 V2,0 m wh	required	101438152

Info: When ordering a module luminaire, the required pictogram with the corresponding arrow direction and other equipment must be indicated.



Info: For luminaires with pendulum mounting, select the desired pendulum (length and colour of baldachin).