

Combined luminaire for general and emergency lighting Luminaire with targeted light output. Robust trapezoidal luminaire housing for wall mounting made of powder-coated die-cast aluminium. High protection rating for outdoor installation. And optional cable entry at the side. Incl. four cable entries for through-wiring to general and emergency lighting.

### Technical data

<b>Material:</b>	die-cast aluminum powder-coated	<b>Apparent power:</b>	7,2 VA
<b>Illuminant:</b>	24 x 0,32W + 9 x 0,32W LED-module	<b>Effective power:</b>	5,9 W
<b>Luminous flux:</b>	360 lm	<b>Inrush current:</b>	6 A / 98 µs
<b>Nominal voltage AC:</b>	230V ±10% 50/60 Hz	<b>Protection class:</b>	I
<b>Nominal voltage DC:</b>	176 - 264 V	<b>Input terminals:</b>	2.5mm <sup>2</sup> feed through wiring
<b>Nominal current AC:</b>	31 mA	<b>Temperature ta:</b>	-15...+40 °C
<b>Nominal current DC:</b>	24 mA	<b>Impact resistance:</b>	IK09

### Technical data (General lighting)

<b>Nominal voltage AC:</b>	230V AC/DC ±10% 50/60 Hz	<b>Light colour:</b>	3000 K
<b>Apparent power:</b>	12,5 VA	<b>Luminous flux:</b>	918 lm
<b>Effective power:</b>	10,4 W	<b>inrush current:</b>	8 A / 50 µs

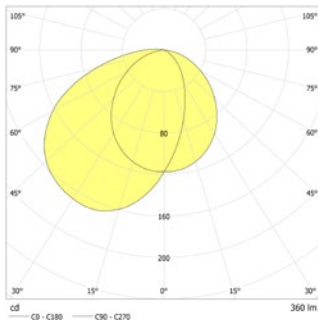

Wall mounting: Minimum illumination 1.0lx

Distance to middle of escape route	Distance to middle of escape route					
	1.0m		2.0m		3.0m	
1.0	2.6	6.3	2.4	6.1	1.1	4.7
1.5	3.2	7.7	3.1	7.7	2.5	7.0
2.0	3.6	8.8	3.6	8.9	3.2	8.5
2.5	4.0	9.7	4.0	9.9	3.7	9.6
3.0	4.3	10.5	4.3	10.7	4.2	10.5
3.5	4.5	11.1	4.5	11.4	4.3	11.2
4.0	4.6	11.7	4.7	12.0	4.5	11.9
4.5	4.8	12.2	4.8	12.5	4.7	12.4
5.0	4.8	12.6	4.9	12.9	4.8	12.9
5.5	4.9	12.9	5.0	13.2	4.8	13.2
6.0	4.9	13.1	5.0	13.5	4.9	13.5

### Articles

SN/A 6201 LED J/SV						
Colors	DB 703	HWF 7015	RAL 7015	RAL 9016	HWF 9016	HWF (special)
Art. no.	104351182	104351384	104350980	104350879	104351283	104351485
wall mounting			Light colour: 3000 K		Protection category: IP65	

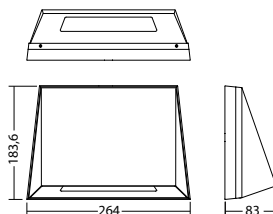

### mounting adapter 6201 RAL 7015

Art. no. 104575292

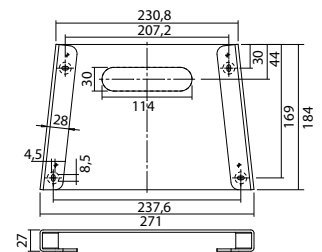

Name	Accessories	Art. no.
J-ET 5.1 SV-max. 24V DC320mA const.	spare part	101422893
LM 176x20 24+9/3K KL LED Modul	spare part	104411911
mounting adapter 6201 RAL 7015	optional	104575292