

230V**SNP 7235-03 AS2 Aluminium luminaires****J/SV**

For connection to JOKER-central battery systems



Double-sided exit sign luminaire made of high-quality aluminum profile. Especially flat design and an efficient and homogeneous illumination of the pictogram, using modern light guide technology. For easy and flexible installation, the cable entry is possible from the rear and from the side.

Incl. INOTEC Spot-Light 2 for illumination of highlighted areas.

**Technical data**

viewing distance:	35 m
Material:	aluminium
Illuminant:	18 x 0,1W + 1 x 1W LED-module
Nominal voltage AC:	230V ±10% 50/60 Hz
Nominal voltage DC:	176 - 264 V
Nominal current AC:	26 mA

Nominal current DC:	23 mA
Apparent power:	6,0 VA
Effective power:	4,8 W
Inrush current:	6 A / 98 µs
Input terminals:	2.5mm ² feed through wiring
Temperature ta:	-15...+40 °C

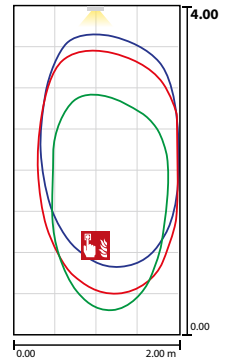
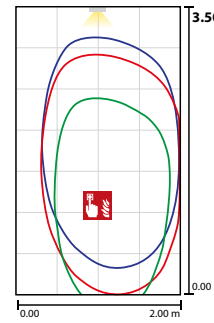
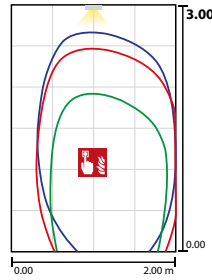
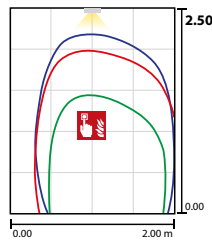
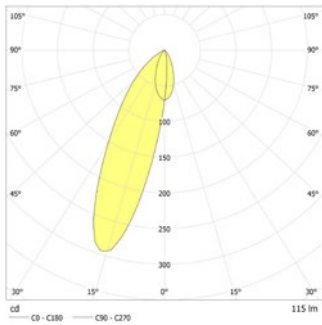
**Articles****SNP 7235 D -03 AS2 LED J/SV**

Colors	Aluminium
Art. no.	102362783

ceiling mounting Light colour: 6500 K Protection category: IP40

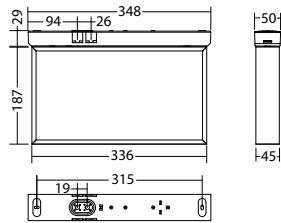
**SNP 7235 S -03 AS2 LED J/SV**

Colors	Aluminium
Art. no.	102362884

cable suspension mounting Light colour: 6500 K Protection category: IP40

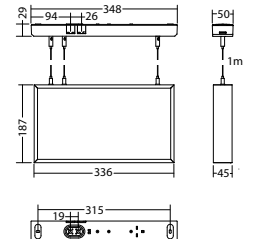

SNP 7235-03 AS2 Aluminium luminaires

For connection to JOKER-central battery systems

Name	Accessories	Art. no.
Blind cover 7x35 green	required	102341767
Blind cover 7x88 / 7x35 grey	required	101203938
Cover 7x88 opal	optional	101203635
J-ET 5.1 SV-max. 24V DC320mA const.	Ersatzteil	101422893
Legend panel 7x35 PL	required	101948212
Legend panel 7x35 PLO	required	101947707
Legend panel 7x35 PLU	required	101947909
Legend panel 7x35 PO	required	101948010
Legend panel 7x35 PR	required	101948111
Legend panel 7x35 PRO	required	101947606
Legend panel 7x35 PRU	required	101947808
Legend panel 7x35 PU	required	101948313
Legend panel 7x35 custom design	required	101871016
Wireset 3m, SNP 101x,10x0,121x,15x0,72xx	required	102384005
Wireset 5m, SNP 101x,10x0,121x,15x0,72xx	optional	102384106
chain mounting adapterSNP 7235	optional	102369150

Info: When ordering an exit luminaire, the required pictogram with the corresponding arrow direction must be indicated.

