

230V

SNP 808 Stainless steel luminaires

NE/SV

For connection to INOTEC-NEA-monitoring systems



Single sided emergency exit luminaires made of robust, brushed stainless steel with high protection category. Homogeneous illumination by state-of-the-art LED technology with a luminance of $>500\text{cd/m}^2$. Suitable for use in food industry or food processing plants with high demands on product hygiene.

Makrolon pictogram for high impact resistance IK10+ (50 joules) available as an option.

**Technical data**

viewing distance:	30 m
Material:	stainless steel brushed
illuminant:	2 x 1W LED-module
Nominal voltage AC:	230V AC $\pm 10\%$ 50/60 Hz
Nominal current AC:	27 mA
Apparent power:	6,1 VA

Effective power:	5,1 W
Inrush current:	8 A / 50 μs
Protection class:	I
Input terminals:	2.5mm ² feed through wiring
Temperature ta:	-15...+40 °C
Impact resistance:	IK10

Articles

SNP 808 LED NE/SV				
Colors	stainless steel	RAL 7015	RAL 9016	HWF 7015
Art. no.	101313163	101313466	101313365	101313264

wall mounting

Light colour: 6500 K

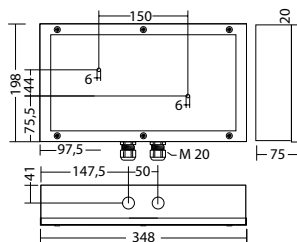
Protection category:
IP65

Name	Accessories	Art. no.
LM 808 185x21,5 2/6,5K KB90	Ersatzteil	101446438
Legend panel 808 / 828 PL	required	101212325
Legend panel 808 / 828 PL without logo	required	101216365
Legend panel 808 / 828 PLO without logo	required	101216870
Legend panel 808 / 828 PLU without logo	required	101216668
Legend panel 808 / 828 PO	required	101212628
Legend panel 808 / 828 PO without logo	required	101216163
Legend panel 808 / 828 PR	required	101212426
Legend panel 808 / 828 PR without logo	required	101216466
Legend panel 808 / 828 PRO without logo	required	101216769
Legend panel 808 / 828 PRU without logo	required	101216567
Legend panel 808 / 828 PU	required	101212527
Legend panel 808 / 828 PU without logo	required	101216264
Legend panel 808 / 828, makrolon	required	101223944
NE - ET 9 / 24 SV -max.24VDC,320mAconst	Ersatzteil	101420570
Piktogrammscheibe 808 / 828Sonder	required	101223742

Info: When ordering an exit luminaire, the required pictogram with the corresponding arrow direction must be indicated.

