



Double-sided emergency exit luminaires made of robust, brushed stainless steel with high protection category. Homogeneous illumination by state-of-the-art LED technology with a luminance of $>500\text{cd/m}^2$. Suitable for use in food industry or food processing plants with high demands on product hygiene.



Technical data

viewing distance:	30 m	Nominal current DC:	200 mA
Material:	stainless steel brushed	Protection class:	III
Illuminant:	4 x 1W LED-module	Input terminals:	2.5mm ² feed through wiring
Nominal voltage DC:	24 V \pm 20 %	Temperature ta:	-15...+40 °C

Articles

SNP 828 K LED 24V

Colors	stainless steel	HWF 9016	RAL 7015	RAL 9016	HWF (special)	RAL (special)
--------	-----------------	----------	----------	----------	---------------	---------------

chain mounting Light colour: 6500 K Protection category: IP65

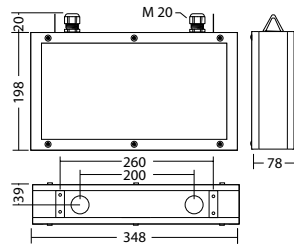

SNP 828 WA LED 24V

Colors	stainless steel
Art. no.	101331553

wall bracket mounting Light colour: 6500 K Protection category: IP65

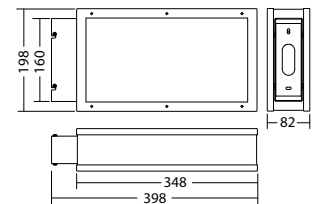

Name	Accessories	Art. no.
Blind cover 808 grey	required	101204746
Cover 808 opal	required	100680138
Legend panel 808 / 828 PL	required	101212325
Legend panel 808 / 828 PL without logo	required	101216365
Legend panel 808 / 828 PLO without logo	required	101216870
Legend panel 808 / 828 PLU without logo	required	101216668
Legend panel 808 / 828 PO	required	101212628
Legend panel 808 / 828 PO without logo	required	101216163
Legend panel 808 / 828 PR	required	101212426
Legend panel 808 / 828 PR without logo	required	101216466
Legend panel 808 / 828 PRO without logo	required	101216769
Legend panel 808 / 828 PRU without logo	required	101216567
Legend panel 808 / 828 PU	required	101212527
Legend panel 808 / 828 PU without logo	required	101216264
special legend panel 808	required	101223742

Info: When ordering an exit luminaire, the required pictogram with the corresponding arrow direction must be indicated.

