

230V

SN 2100 Polycarbonate luminaires

NE/SV

For connection to INOTEC-NEA-monitoring systems



Universal LED downlight ideal for area or escape route illumination. UV resistant, heat filament tested polycarbonate housing with optional side cable entry and comfortable installation space.



Technical data

Material:	polycarbonate
Illuminant:	4 x 1W LED-module
Luminous flux:	338 lm
Nominal voltage AC:	230V AC ±10% 50/60 Hz
Nominal current AC:	36 mA
Apparent power:	8,3 VA

Effective power:	7,4 W
Inrush current:	8 A / 50 µs
Protection class:	II
Input terminals:	2.5mm ² feed through wiring
Temperature ta:	-15...+40 °C
Impact resistance:	IK06

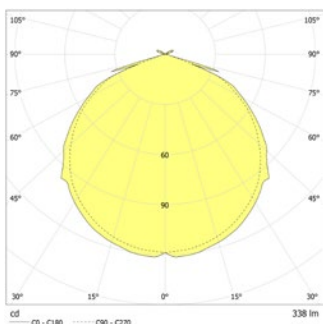

Ceiling mounting: Minimum illumination 1.0lx (middle of escape route), Maintenance factor 0.8

Beam diameter [m]	2.5	4.0	10.0	10.3	4.0
2.5	4.0	10.8	11.0	4.3	
3.0	4.6	12.0	12.3	4.8	
4.0	4.7	12.8	13.1	4.9	
5.0	4.6	13.2	13.7	4.9	
6.0	4.3	13.4	13.9	4.4	
7.0	3.7	13.3	13.9	3.8	
8.0	2.5	13.0	13.3	2.7	
9.0	1.7	12.1	12.9	1.9	
10.0					

Minimum illumination 1.0lx (area illumination), Maintenance factor 0.8

Beam diameter [m]	2.5	2.7	8.4	8.5	2.7
2.5	2.9	9.1	9.2	2.9	
3.0	3.0	10.4	10.5	3.0	
4.0	3.0	11.5	11.6	3.0	
5.0	3.0	12.3	12.4	3.0	
6.0	3.2	12.5	12.6	3.2	
7.0	3.1	12.5	12.6	3.1	
8.0	2.8	12.2	12.1	2.8	
9.0	2.3	12.0	12.1	2.3	
10.0					

Articles

SN 2100 LED NE/SV	
Colors	Polycarbonat
Art. no.	101264764

ceiling mounting Light colour: 6500 K Protection category: IP40

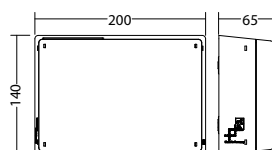

SN 2100 LED NE/SV	
Colors	Polycarbonat
Art. no.	101265471

ceiling mounting Light colour: 6500 K Protection category: IP65

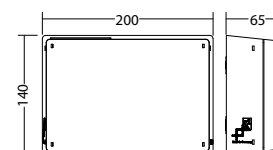

chain mounting adapter SN 2100	Art. no. 100923042
---------------------------------------	--------------------

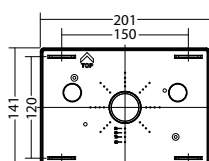

Name	Accessories	Art. no.
LED replacement kit SN 2100	Ersatzteil	101942754
NE - ET 9 / 24 SV -max.24VDC,320mAconst	Ersatzteil	101420570
chain mounting adapter SN 2100	optional	100923042
clear cover SN 2100 LED	Ersatzteil	100612541

