



Universal LED downlight for mounting height up to 18m, ideal for illumination of 3m – 4m wide escape routes. UV resistant, heat filament tested polycarbonate housing with optional side cable entry and comfortable installation space.

Technical data

Material:	polycarbonate
Illuminant:	4 x 1W LED-module
Luminous flux:	329 lm
Nominal voltage AC:	230V ±10% 50/60 Hz
Nominal voltage DC:	176 - 264 V
Nominal current AC:	27 mA
Nominal current DC:	28 mA

Apparent power:	6,3 VA
Effective power:	6,0 W
Inrush current:	6 A / 22 µs
Protection class:	II
Input terminals:	2.5mm ² feed through wiring
Temperature ta:	-15...+40 °C
Impact resistance:	IK06

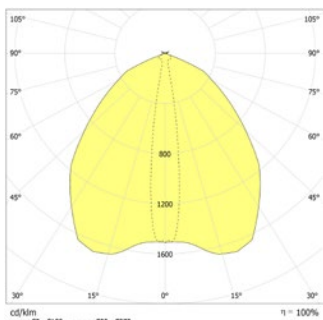

Ceiling mounting: Minimum illumination 1.0lx (middle of escape route), Maintenance factor 0.8

Mounting height [m]	Beam diameter [m]	Beam diameter [m]	Maximum escape route width for area illumination with 1.25lx
8.0	7.1	18.0	
9.0	7.6	20.5	
10.0	8.0	21.6	
11.0	8.2	22.5	
12.0	7.0	21.1	
13.0	7.1	22.2	
14.0	7.1	22.6	
15.0	7.0	23.3	
16.0	7.4	24.6	
17.0	6.8	24.7	
18.0	6.4	24.6	

Articles

SN 2100 TB FLD 230V	
Colors	Polycarbonat
Art. no.	100855041

ceiling mounting Light colour: 6500 K Protection category: IP40

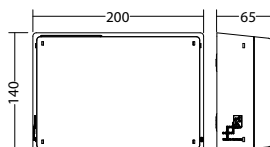

SN 2100 TB FLD 230V	
Colors	Polycarbonat
Art. no.	100855142

ceiling mounting Light colour: 6500 K Protection category: IP65

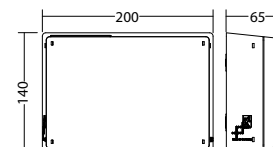

chain mounting adapter SN 2100	Art. no. 100923042
---------------------------------------	--------------------

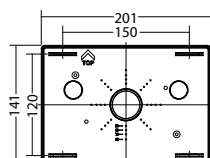

Name	Accessories	Art. no.
FLD 230/8 – CC – 320 – C	Ersatzteil	100903238
LED replacement kit SN 2100 TB	Ersatzteil	101944471
chain mounting adapter SN 2100	optional	100923042
clear cover SN 2100 LED	Ersatzteil	100612541