



Universal LED downlight for mounting height up to 20m, ideal for area or escape route illumination. UV resistant, heat filament tested polycarbonate housing with optional side cable entry and comfortable installation space.



Technical data

Material:	polycarbonate
Illuminant:	4 x 1W LED-module
Luminous flux:	281 lm
Nominal voltage DC:	24 V ±25 %
Nominal current DC:	210 mA

Protection class:	III
Input terminals:	2.5mm ² feed through wiring
Temperature ta:	-15...+40 °C
Impact resistance:	IK06

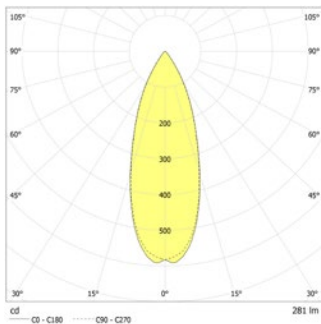

Ceiling mounting: Minimum illumination 1.0lx (middle of escape route), Maintenance factor 0.8

Height [m]	8.0	9.0	10.0	11.0	12.0	13.0	14.0	15.0	16.0	17.0	18.0	19.0	20.0
4.3	4.3	4.5	4.7	4.7	4.7	4.7	4.6	4.5	4.4	4.2	3.9	3.5	2.9
10.3	10.3	11.0	11.7	12.2	12.7	13.0	13.2	13.4	13.5	13.5	13.4	13.3	13.2
10.4	10.4	11.1	11.8	12.3	12.7	13.1	13.3	13.5	13.5	13.5	13.5	13.4	13.3
4.4	4.4	4.6	4.7	4.7	4.7	4.7	4.7	4.6	4.5	4.3	4.0	3.6	3.1

Minimum illumination 1.0lx (area illumination), Maintenance factor 0.8

Height [m]	10.0	11.0	12.0	13.0	14.0	15.0	16.0	17.0	18.0	19.0	20.0
3.5	3.5	3.5	3.5	3.5	3.4	3.2	3.2	3.1	3.0	2.9	2.7
9.5	9.5	10.1	10.5	11.1	11.5	11.8	11.8	12.0	12.0	11.8	11.3
9.5	9.5	10.1	10.5	11.1	11.5	11.8	11.8	12.0	12.0	11.8	11.3
3.6	3.6	3.5	3.5	3.5	3.4	3.2	3.2	3.1	3.0	2.9	2.7

Articles

SN 2100 T LED 24V

Colors	Polycarbonat
Art. no.	101340243

ceiling mounting Light colour: 6500 K Protection category: IP40

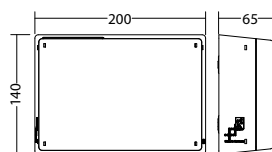

SN 2100 T LED 24V

Colors	Polycarbonat
Art. no.	101340344

ceiling mounting Light colour: 6500 K Protection category: IP65

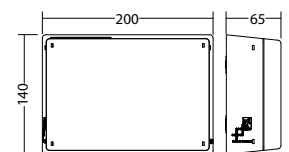

chain mounting adapter SN 2100

Art. no. 100923042

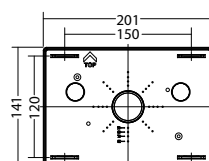

Name	Accessories	Art. no.
ILD 24/4-CC-320-C	Ersatzteil	101425321
LED replacement kit SN 2100 T	Ersatzteil	101942956
chain mounting adapter SN 2100	optional	100923042
clear cover SN 2100 LED	Ersatzteil	100612541