

**230V****SN 2100 T Polycarbonate luminaires****J/SV**

For connection to JOKER-central battery systems



Universal LED downlight for mounting height up to 20m, ideal for area or escape route illumination. UV resistant, heat filament tested polycarbonate housing with optional side cable entry and comfortable installation space.

**Technical data**

<b>Material:</b>	polycarbonate
<b>Illuminant:</b>	4 x 1W LED-module
<b>Luminous flux:</b>	281 lm
<b>Nominal voltage AC:</b>	230V ±10% 50/60 Hz
<b>Nominal voltage DC:</b>	176 - 264 V
<b>Nominal current AC:</b>	36 mA
<b>Nominal current DC:</b>	32 mA

<b>Apparent power:</b>	8,3 VA
<b>Effective power:</b>	7,4 W
<b>Inrush current:</b>	8 A / 50 µs
<b>Protection class:</b>	II
<b>Input terminals:</b>	2.5mm <sup>2</sup> feed through wiring
<b>Temperature ta:</b>	-15...+40 °C
<b>Impact resistance:</b>	IK06

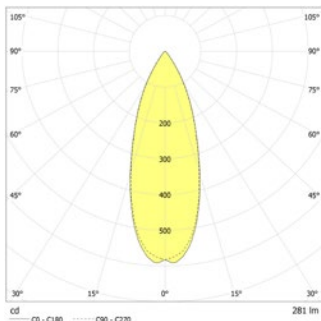

Ceiling mounting: Minimum illumination 1.0lx (middle of escape route), Maintenance factor 0.8

Height [m]	1.0lx	1.5lx	2.0lx	3.0lx	4.0lx
8.0	4.3	10.3	10.4	4.4	
9.0	4.5	11.0	11.1	4.6	
10.0	4.7	11.7	11.8	4.7	
11.0	4.7	12.2	12.3	4.7	
12.0	4.7	12.7	12.7	4.7	
13.0	4.7	13.0	13.1	4.7	
14.0	4.6	13.2	13.3	4.7	
15.0	4.5	13.4	13.5	4.6	
16.0	4.4	13.5	13.5	4.5	
17.0	4.2	13.5	13.5	4.3	
18.0	3.9	13.4	13.5	4.0	
19.0	3.5	13.3	13.4	3.6	
20.0	2.9	13.2	13.3	3.1	

Minimum illumination 1.0lx (area illumination), Maintenance factor 0.8

Height [m]	1.0lx	1.5lx	2.0lx	3.0lx	4.0lx
10.0	3.5	9.5	9.5	3.6	
11.0	3.5	10.1	10.1	3.5	
12.0	3.5	10.5	10.5	3.5	
13.0	3.5	11.1	11.1	3.5	
14.0	3.4	11.5	11.5	3.4	
15.0	3.2	11.8	11.8	3.2	
16.0	3.2	11.8	11.8	3.2	
17.0	3.1	12.0	12.0	3.1	
18.0	3.0	12.0	12.0	3.0	
19.0	2.9	11.8	11.8	2.9	
20.0	2.7	11.3	11.3	2.7	

**Articles****SN 2100 T LED J/SV**

Colors	Polycarbonat
Art. no.	101266380

ceiling mounting      Light colour: 6500 K      Protection category: IP40

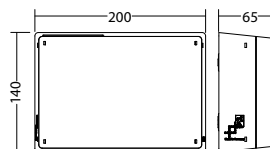
**SN 2100 T LED J/SV**

Colors	Polycarbonat
Art. no.	101266784

ceiling mounting      Light colour: 6500 K      Protection category: IP65

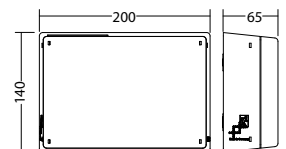
**chain mounting adapter SN 2100**

Art. no. 100923042

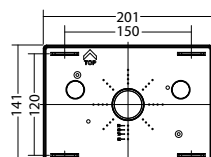

Name	Accessories	Art. no.
J - ET 9 / 24 SV -max.24VDC,320mAconst	Ersatzteil	101420267
LED replacement kit SN 2100 T	Ersatzteil	101942956
chain mounting adapter SN 2100	optional	100923042
clear cover SN 2100 LED	Ersatzteil	100612541

