

Ball-impact and shock resistant safety luminaires with state-of-the-art LED-technology for area or escape route illumination. Powder-coated aluminium housing with slim design, perfect for use in environments with high mechanical stresses and in sports facilities.



Technical data

Material:	sheet steel powder-coated
Illuminant:	4 x 1W LED-module
Luminous flux:	310 lm
Nominal voltage AC:	230V ±10% 50/60 Hz
Nominal voltage DC:	176 - 264 V
Nominal current AC:	36 mA
Nominal current DC:	32 mA

Apparent power:	8,3 VA
Inrush current:	8 A / 50 µs
Protection class:	I
Input terminals:	2.5mm ² feed through wiring
Temperature ta:	-15...+40 °C
Impact resistance:	IK10

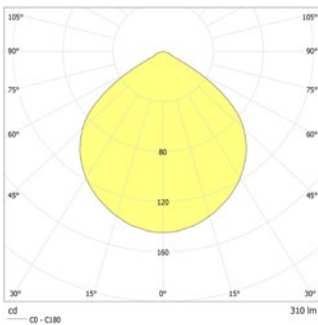

Ceiling mounting: Minimum illumination 1.0lx (middle of escape route), Maintenance factor 0.8

[m]	2.5	3.7	8.5
2.5	3.0	4.1	9.7
4.0	4.7	11.5	
5.0	5.0	12.9	
6.0	5.1	13.9	
7.0	4.9	14.3	
8.0	4.5	14.4	
9.0	3.7	14.3	
10.0	2.5	13.8	

Minimum illumination 1.0lx (area illumination), Maintenance factor 0.8

[m]	2.5	2.7	6.4
2.5	3.0	3.1	7.3
4.0	3.6	9.0	
5.0	3.7	10.6	
6.0	3.7	11.8	
7.0	3.6	12.4	
8.0	3.4	12.8	
9.0	3.1	12.6	
10.0	2.6	12.4	

Articles

SN 8030 AP LED J/SV

Colors	RAL 7015	RAL 9016
Art. no.	101311547	101311446

ceiling mounting for exposed wiring Light colour: 6500 K Protection category: IP40

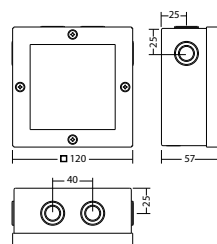

SN 8030 D LED J/SV

Colors	RAL 9016	RAL (special)
Art. no.	101310840	101311143

ceiling mounting Light colour: 6500 K Protection category: IP40

