

Ball-impact and shock resistant safety luminaires with state-of-the-art LED-technology for area or escape route illumination. Powder-coated aluminium housing with slim design, perfect for use in environments with high mechanical stresses and in sports facilities.



Technical data

Material:	sheet steel powder-coated
Illuminant:	4 x 1W LED-module
Luminous flux:	310 lm
Nominal voltage AC:	230V AC ±10% 50/60 Hz
Nominal current AC:	36 mA
Apparent power:	8,3 VA

Inrush current:	8 A / 50 µs
Protection class:	I
Input terminals:	2.5mm ² feed through wiring
Temperature ta:	-15...+40 °C
Impact resistance:	IK10

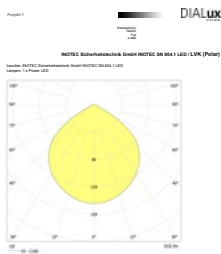

Ceiling mounting: Minimum illumination 1.0lx (middle of escape route), Maintenance factor 0.8

[m]	2.5	3.7	8.5
2.5	3.0	4.1	9.7
3.0	4.0	4.7	11.5
4.0	5.0	5.0	12.9
5.0	6.0	5.1	13.9
6.0	7.0	4.9	14.3
7.0	8.0	4.5	14.4
8.0	9.0	3.7	14.3
10.0	10.0	2.5	13.8

Minimum illumination 1.0lx (area illumination), Maintenance factor 0.8

[m]	2.5	2.7	6.4
2.5	3.0	3.1	7.3
3.0	4.0	3.6	9.0
4.0	5.0	3.7	10.6
5.0	6.0	3.7	11.8
6.0	7.0	3.6	12.4
7.0	8.0	3.4	12.8
8.0	9.0	3.1	12.6
10.0	10.0	2.6	12.4

Articles

SN 8030 AP LED NE/SV		
Colors	RAL 9016	
Art. no.	101311749	
ceiling mounting for exposed wiring	Light colour: 6500 K	Protection category: IP40

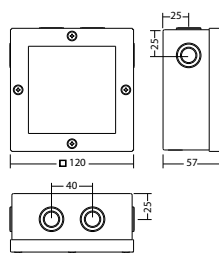

SN 8030 D LED NE/SV		
Colors	RAL 9016	
Art. no.	101311244	
ceiling mounting	Light colour: 6500 K	Protection category: IP40

