



LED safety luminaire with optimised light distribution for the illumination of small areas such as lavatories or electrical operating rooms with a luminaire. Recessed ceiling luminaires with powder-coated aluminium trim without visible screws. For installation in Ø 68mm socket. Incl. 4-chip LED illuminant for maximum safety.



Technical data

Material:	die-cast aluminum powder-coated
Illuminant:	1 x 0,9W LED-module
Luminous flux:	146 lm
Nominal voltage DC:	24 V ±20 %

Nominal current DC:	80 mA
Protection class:	III
Input terminals:	2.5mm ² feed through wiring
Temperature ta:	-15...+40 °C

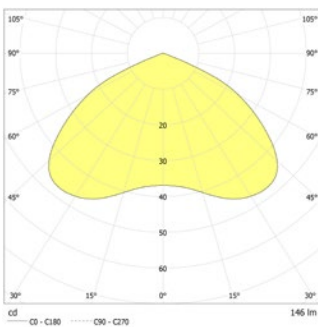

Ceiling mounting: Minimum illumination 1.0lx (middle of escape route), Maintenance factor 0.8

[m]	1	2
2.5	3.3	8.2
3.0	3.5	8.8
3.5	3.6	9.4
4.0	3.5	9.8
4.5	3.2	10.0
5.0	2.7	10.1

Minimum illumination 1.0lx (area illumination), Maintenance factor 0.8

[m]	1	2
2.5	2.2	6.8
3.0	2.3	7.4
3.5	2.5	8.0
4.0	2.6	8.4
4.5	2.5	8.6
5.0	2.4	8.2

Articles

SN 9424 -03 SLB LED 24V round

Colors	RAL 9005	RAL 9016	RAL (special)
Art. no.	102065117	101360956	101361057
switch box installation	Light colour: 4000 K		Protection category: IP20

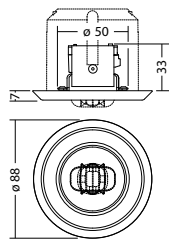

SN 9424 -03 SLB LED 24V square

Colors	RAL 9005	RAL 9016	RAL (special)
Art. no.	102065319	101361360	101361461
switch box installation	Light colour: 4000 K		Protection category: IP20

